

(2 to 4 circuits)

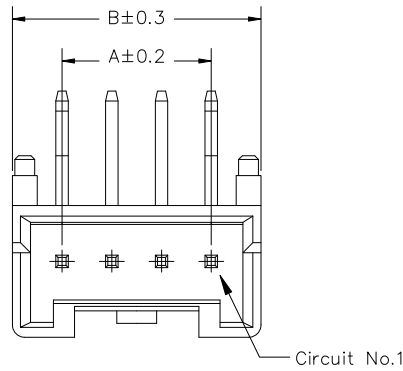

(5 to 6 circuits)

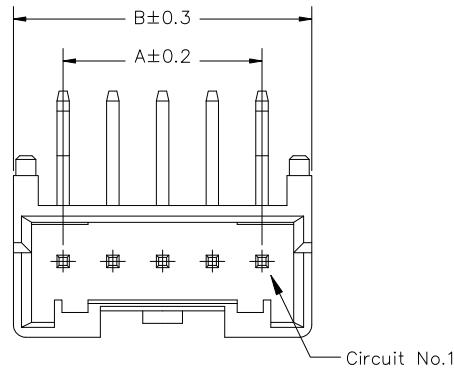

### Specifications

Current Rating: 3A AC/ DC (Max)AWG#22  
 Voltage Rating: 250V AC/ DC  
 Temperature Range: -25°C ~ + 85°C  
 Contact Resistance: 20mΩ Max  
 Insulation Resistance: 1000MΩ Min  
 Withstand Voltage:800V AC/Minute  
 Pin Material: Brass/ Tin-plated  
 Wafer Material: Glass-filled,PBT,UL94V-0,natural

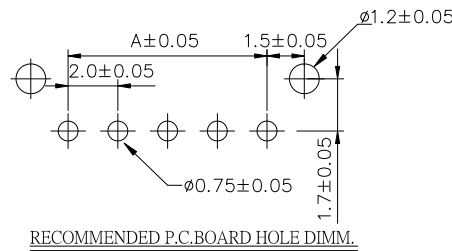
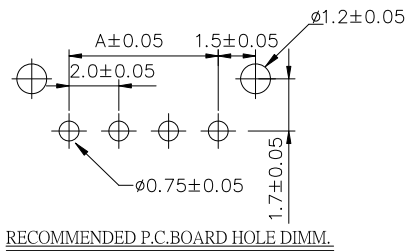
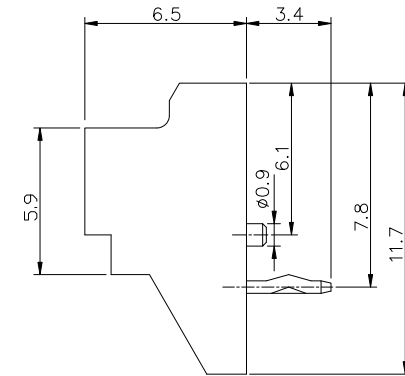
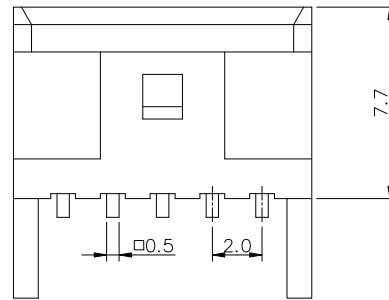
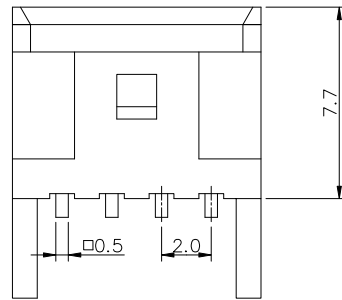

Poles	Dimension mm (in.)		Part No.	Note.
	A	B		
02	2.0(0.079)	6.0(0.236)	CPA-W20R-02	
03	4.0(0.157)	8.0(0.315)	CPA-W20R-03	
04	6.0(0.236)	10.0(0.394)	CPA-W20R-04	
05	8.0(0.315)	12.0(0.472)	CPA-W20R-05	
06	10.0(0.394)	14.0(0.551)	CPA-W20R-06	
07	12.0(0.472)	16.0(0.630)	CPA-W20R-07	
08	14.0(0.551)	18.0(0.709)	CPA-W20R-08	
09	16.0(0.630)	20.0(0.787)	CPA-W20R-09	
10	18.0(0.709)	22.0(0.866)	CPA-W20R-10	
11	20.0(0.787)	24.0(0.945)	CPA-W20R-11	
12	22.0(0.866)	26.0(1.024)	CPA-W20R-12	
13	24.0(0.945)	28.0(1.102)	CPA-W20R-13	
14	26.0(1.024)	30.0(1.181)	CPA-W20R-14	
15	28.0(1.102)	32.0(1.260)	CPA-W20R-15	



DESCRIPTION(內容):  
**2.0mm Wire-to-Board Header  
 DIP 90° Type (RoHS)**  
 PART NO:  
 (料 號) CPA-W20R-XX  
 DWG NO(圖號): 2001PA-XX-RT-D

DRAWN(製圖):  
**GONG**  
 CHECKED(確認):  
**MANDY**  
 APPROVAL(核准):  
**JOHNNY**

GENERAL TOLERANCE:  
 (公差)  
 X.XX ±0.20  
 X.X ±0.25  
 SCALE(比例):  
**FREE**

REV:  
**R3**  
 UNIT:  
**mm**  
 SIZE:  
**A4**  
 SHEET:  
**1/2**

REV  
**R0**  
**R1**  
**R2**  
**R3**

DESCRIPTION  
 RELEASE  
 修正尺寸7.7mm標示位子  
 2014年料號編碼統一兩碼  
 圖面更新

DATE  
**2009.03.12**  
**2010.03.04**  
**2014.09.25**  
**2020.02.06**

(7 to 9 circuits)

(10 to 15 circuits)

### Specifications

- Current Rating: 3A AC/ DC (Max)AWG#22
- Voltage Rating: 250V AC/ DC
- Temperature Range: -25°C ~ + 85°C
- Contact Resistance: 20mΩ Max
- Insulation Resistance: 1000MΩ Min
- Withstand Voltage:800V AC/Minute
- Pin Material: Brass/ Tin-plated
- Wafer Material: Glass-filled,PBT,UL94V-0,natural

1

1

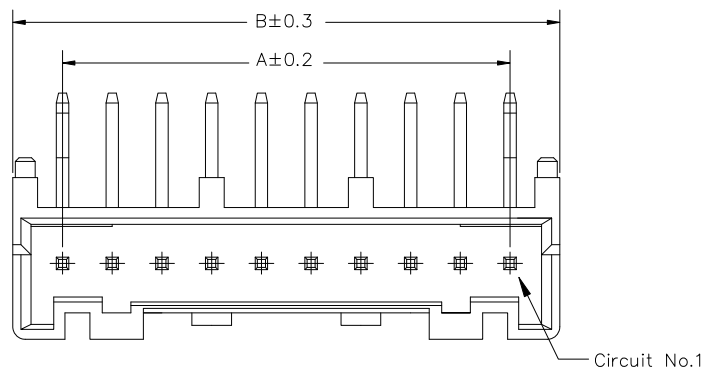
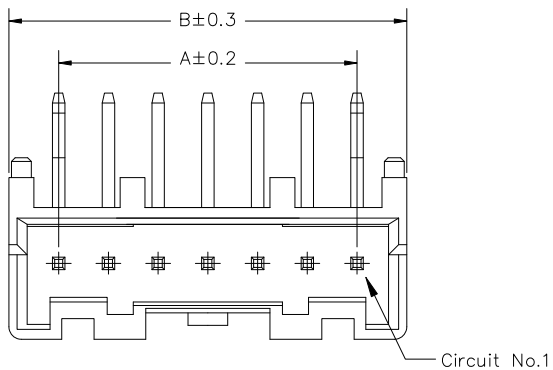

2

2

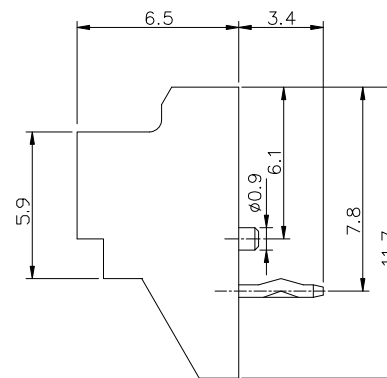
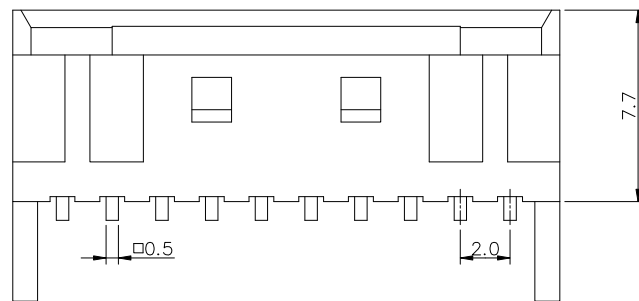
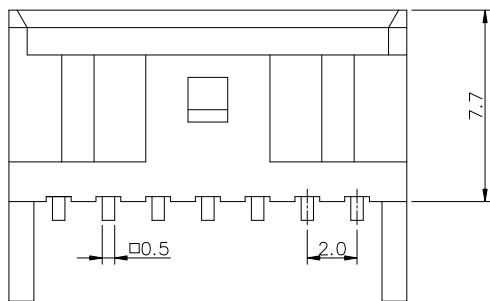

3

3

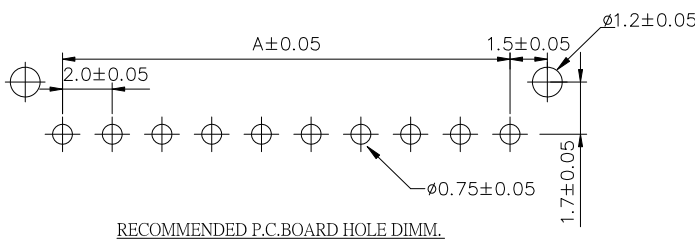
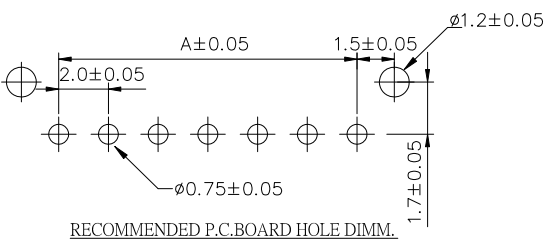

Poles	Dimension mm (in.)		Part No.	Note.
	A	B		
02	2.0(0.079)	6.0(0.236)	CPA-W20R-02	
03	4.0(0.157)	8.0(0.315)	CPA-W20R-03	
04	6.0(0.236)	10.0(0.394)	CPA-W20R-04	
05	8.0(0.315)	12.0(0.472)	CPA-W20R-05	
06	10.0(0.394)	14.0(0.551)	CPA-W20R-06	
07	12.0(0.472)	16.0(0.630)	CPA-W20R-07	
08	14.0(0.551)	18.0(0.709)	CPA-W20R-08	
09	16.0(0.630)	20.0(0.787)	CPA-W20R-09	
10	18.0(0.709)	22.0(0.866)	CPA-W20R-10	
11	20.0(0.787)	24.0(0.945)	CPA-W20R-11	
12	22.0(0.866)	26.0(1.024)	CPA-W20R-12	
13	24.0(0.945)	28.0(1.102)	CPA-W20R-13	
14	26.0(1.024)	30.0(1.181)	CPA-W20R-14	
15	28.0(1.102)	32.0(1.260)	CPA-W20R-15	

**承洧科技股份有限公司**  
Cherg Weei Technology Corp.

DESCRIPTION(內容):  
**2.0mm Wire-to-Board Header  
DIP 90° Type (RoHS)**

PART NO:  
(料 號) **CPA-W20R-XX**

DWG NO(圖號): **2001PA-XX-RT-D**

DRAWN(製圖):  
**GONG**

CHECKED(確認):  
**MANDY**

APPROVAL(核准):  
**JOHNNY**

GENERAL TOLERANCE:  
(公差)  
X.XX ±0.20  
X.X ±0.25

SCALE(比例):  
**FREE**

REV: **R3**

UNIT:  
**mm**

SIZE:  
**A4**

SHEET:  
**2/2**

REV	DESCRIPTION	DATE
<b>R0</b>	RELEASE	<b>2009.03.12</b>
<b>R1</b>	修正尺寸7.7mm標示位子	<b>2010.03.04</b>
<b>R2</b>	2014年料號編碼統一兩碼	<b>2014.09.25</b>
<b>R3</b>	圖面更新	<b>2020.02.06</b>

A

B

C

D

E