

Specifications

Current Rating : 3A AC, DC
 Voltage rating : 250V AC, DC
 Temperature range : -25° C ~ +85° C
 Contact resistance : 10m Ω Max
 Insulation resistance : 500M Ω Min
 Withstanding voltage : 1500V AC/minute
 Finished : Tin-plated
 Housing Material : Nylon-66, UL94V-0
 Color : Nature

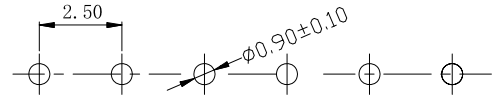
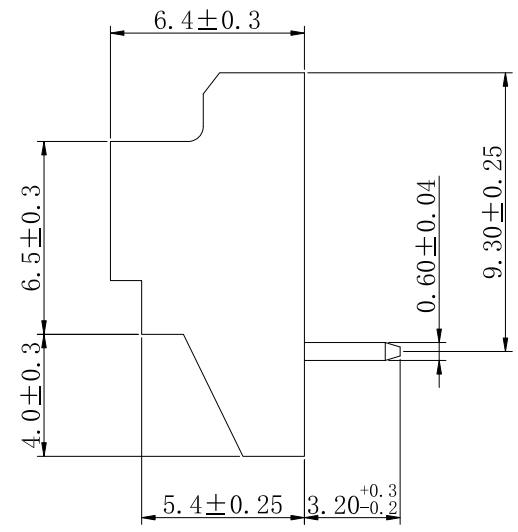
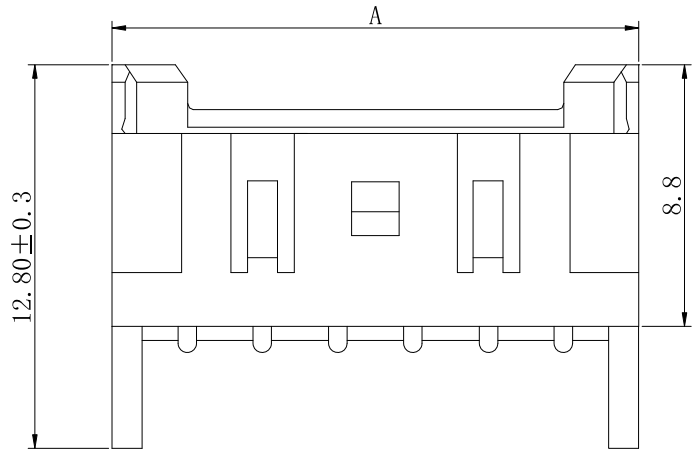

Recommant PCB Layout

Part No.	A	B	C
CXA-W250R-02	7.50	5.80	2.50
CXA-W250R-03	10.00	8.30	5.00
CXA-W250R-04	12.50	10.80	7.50
CXA-W250R-05	15.00	13.30	10.00
CXA-W250R-06	17.50	15.80	12.50
CXA-W250R-07	20.00	18.30	15.00
CXA-W250R-08	22.50	20.80	17.50
CXA-W250R-09	25.00	23.30	20.00
CXA-W250R-10	27.50	25.80	22.50
CXA-W250R-11	30.00	28.30	25.00
CXA-W250R-12	32.50	30.80	27.50
CXA-W250R-13	35.00	33.30	30.00
CXA-W250R-14	37.50	35.80	32.50
CXA-W250R-15	40.00	38.30	35.00



DESCRIPTION(内容):
XA2.5mm Wafer 90°(RoHS)
 PART NO:
 (料 號) **CXA-W250R-XX**
 DWG NO(圖號):

DRAWN(製圖):
 黃炳秋
 CHECKED(確認):
 黃炳秋
 APPROVAL(核准):
 鄧文广
 GENERAL TOLERANCE:
 (公差)
 .X ±0.30
 .XX ±0.20
 .XXX ±0.10
 SCALE(比例):
 1:XX

REV	DESCRIPTION	DATE
A/1		
1		2021.11.15
2		
3		
4		